

FORCE70AC – EASY CONTROL

Our new single phase industrial door openers are a smart choice for your industrial door automation. Select three levels of control depending on your budget, on your need for convenience or on the wish for additional features and accessories. Freedom of choice!

Force70AC offers 70Nm power, logical “force” branding, nice packaging and is pre-wired ready for installation. Equipped with quick release. Mechanical limit switches. Automatic control, with one push-button for simply automating an industrial door.

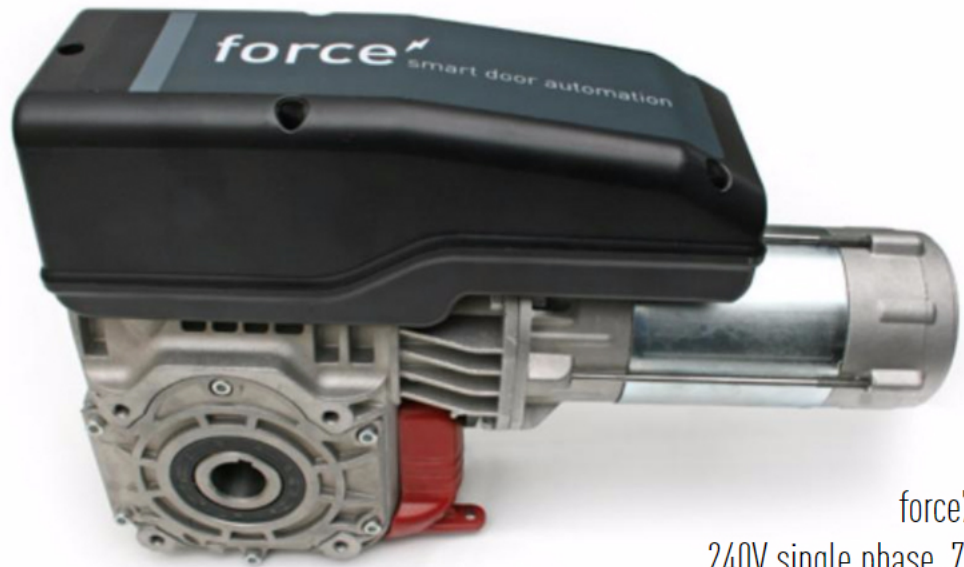

force70AC
240V single phase, 70Nm
automatic control

flexiforce^{FF}

TECHNICAL FEATURES / DATI TECNICI CARACTERISTIQUES TECHNIQUES / DATOS TECNICOS TECHNISCHE DATEN / TECHNISCHE GEGEVENS

Torque / Coppia Couple / Par Drehmoment / Koppel	70 Nm	Frequency / Frequenza Fréquence / Frecuencia Frequenz / Frequentie	50 Hz	Power / Potenza Puissance / Potencia Leistung / vermogen	0.50 kW
Speed / Velocità Vitesse / Velocidad Drehzahl / snelheid	21 rpm	Absorption / Assorbimento Absorption / Absorción Stromaufnahme / Stroomopname	2.20 A	Hollow shaft Diametro albero Diamètre de l'arbre Eje Hohlwell Holle as	25.4 mm
Power Supply Alimentazione Alimentation Alimentación Stromversorgung voeding	230 V~	Working temperature Temperatura di funzionamento Temperature de fonctionnement Temperatura de servicio Betriebstemperatur Werk temperatuur	-10°C / 40°C	Protection / Protezione Protection / Protección Schutzart / IP waarde	IP 54
Max. door weight Peso massimo porta Max. poids porte Max. Peso puerta Max. Torgewicht Max. deurgewicht	350 Kg	Max Cycles Per Hour Max cicli/ora Nbre max de cycles/heure Max ciclos/hora Max. Zyklen pro Stunde Max. cyclussen per uur	12	Limit Switch range N.ro di giri controllati Tours max cage fins de courses Número de vueltas máx Endschalter-Bereich Einschakelaar bereik	18
Holding torque Coppia di tenuta Couple de maintien Par de retención Haltemoment Houdkoppel	450 Nm	Max/Min Absorption Max/Min Assorbimento Max/Min Absorption Max/Min Absorción Max./min. Stromaufnahme Max/Min opname	6 / 0.1 A		
Functioning time Tempo di lavoro Temps de fonctionnement Tiempo de funcionamiento Funktionsdauer Looptijd	max 2 min	Closing time Tempo di chiusura Temps de fermeture Tiempo de cierre Schließzeit Automatische sluit tijd	max 2 min	Code combinations Combinazione di codici Combinaisons de code Combinaciones de códigos Code-Kombinationen Code combinatie handzender	72.000 billion
Number of Codes Numero di codici Nombre de codes Numero de codigos Anzahl der Codes Aantal handzenders	31	Distance / Distanza Distance / Distancia Entfernung / Bereik handzender	Max 60 mt	Frequency / Frequenza Fréquence / Frecuencia Frequenz / Frequentie	433.92 MHz
Sensitivity (better than) Sensibilità (migliore di) Sensibilité (mieux de) Sensibilidad (mejor de) Empfindlichkeit (besser als) Gevoeligheid (beter dan)	-100 dBm	Code Programming Self-taught Programmazione codici: auto-apprendimento Programmation codes: auto-apprendissage Programación codigos: auto-aprendizaje Code-Programmierung selbstlernend Code Programming: zelf lerend		Antenna: integrated Antenna: Incorporata Antenne: intergrée Antenna: Integrada Antenne: integriert Antenne: geïntegreerd	

FIG. 1

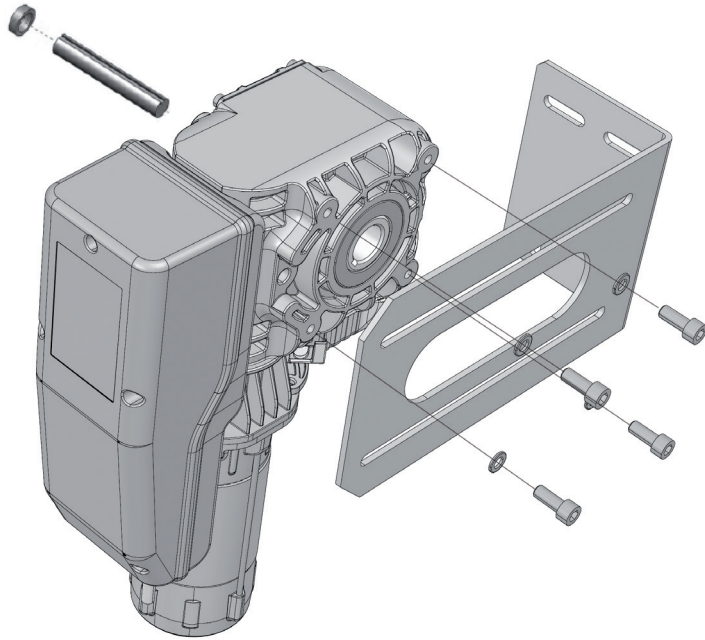
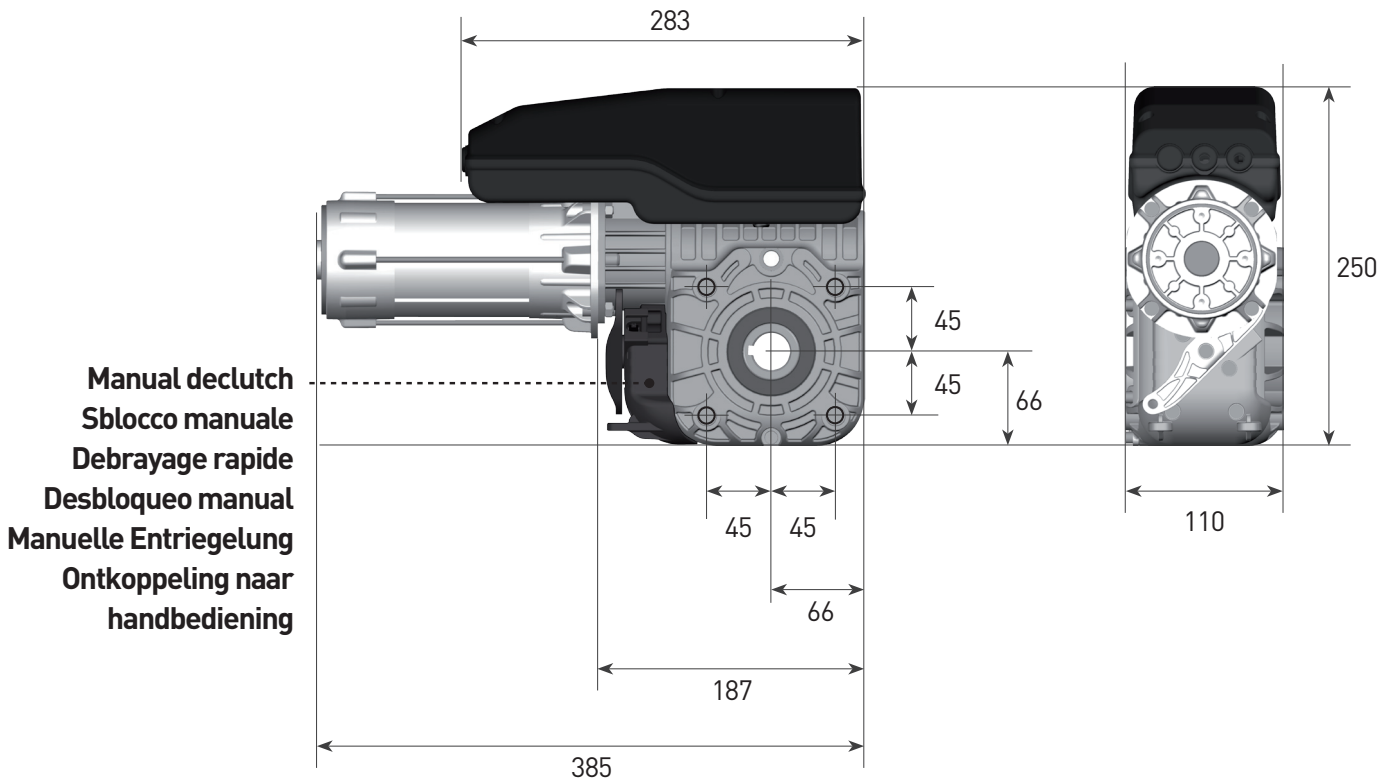

FIG. 2



Declaration of Incorporation

We

FlexiForce Group BV
PO Box 37
3770 AA Barneveld
The Netherlands

Hereby declare under sole responsibility that the type of equipment:

Description of the partially completed machinery

Function	Electrical industrial door operator
Model	force70AC

complies with the following directives:

EMC Directive 2004/108/CE
Low Voltage Directive 2006/95/CE
Machinery Directive 2006/42/CE
EN 12604
EN 12605

Harmonized standards applied

EN 61000-6-1	EN 60335-2-95
EN 61000-6-3	EN 60335-2-97
EN 60335-1	EN 60335-2-103

Other applied standards

EN 12453	EN 300 220-1 V2.21
EN12445	EN 301 489-1 V1.4.1
EN 12978	EN 301 489-3 V1.4.1
EN 60730-1	

The manufacturing process ensures the compliance of the equipment with the technical file.

A door operator, in combination with an automatic door system must be installed and maintained according to all manufacturer's instructions, to meet the provisions of EN12453 and EN13241-1. The equipment must not be used until the final installed door system had been declared in compliance with the machine directive 2006/42/EC by the installation company.

On demand we submit these technical documents to the market supervisory authorities within a reasonable time.

Compilation of technical file:

Ton Peterse

Flexi-Force Group BV
 Hanzeweg 25
 3771 NG Barneveld
 The Netherlands

Place	Date
Barneveld	11-11-2015

	Signature	Position
Ronald Koenders		Supply Chain Director